

OLTENS

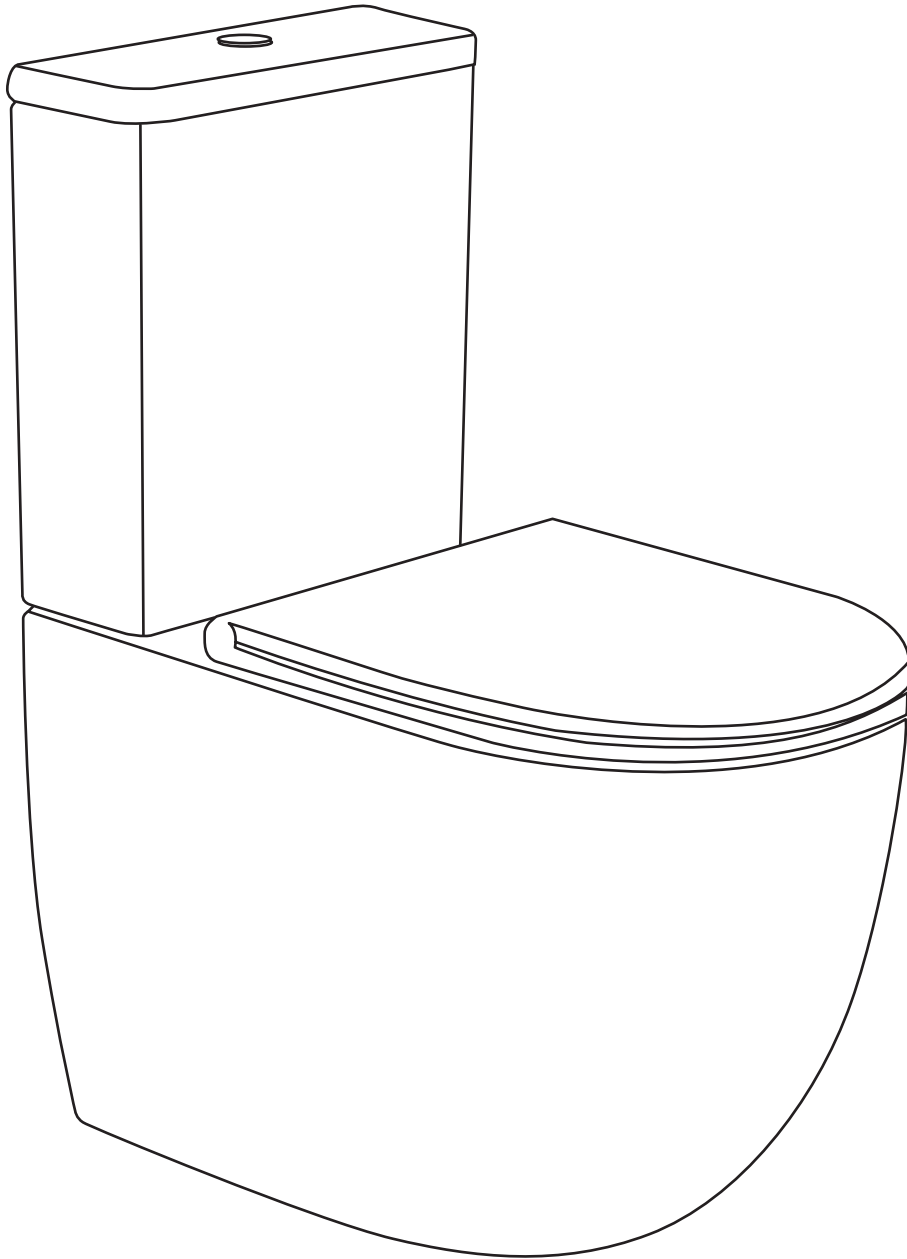

Installation Manual of **Tank Fitting**

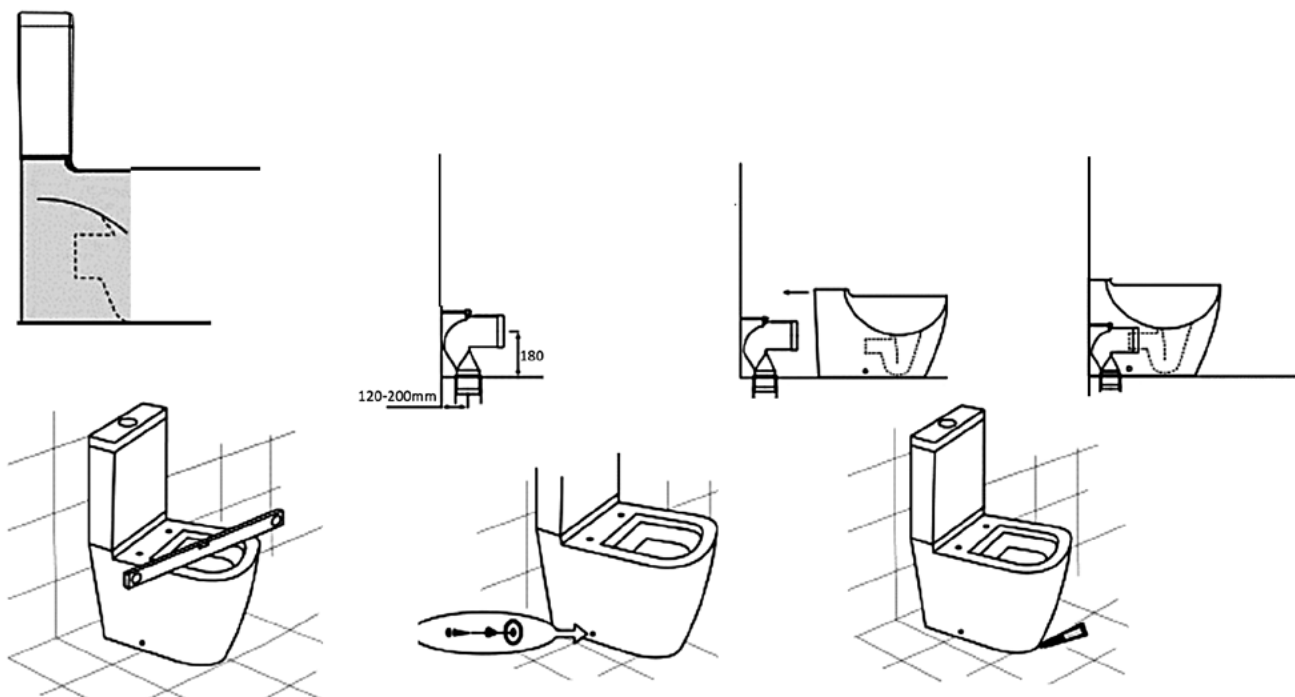

Installation of a cistern for a ceramic bowl



1. Parts needed to install a cistern on a ceramic toilet bowl.

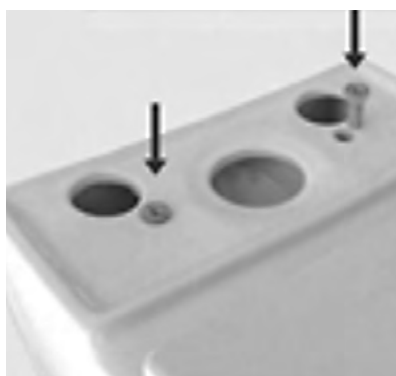

2. The tank screws are screwed into the bowl. Tighten from below.



3. Ensure that the rubber seal is installed in the tank.



4. Place the container on a ceramic bowl.



5. Use the screws provided to attach the tank to the bowl.

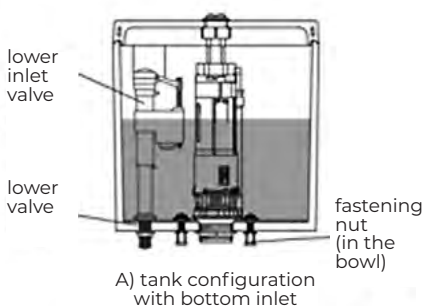

6. Drain valve components in the tank.

After attaching the compact unit according to the instructions, connect the water supply and make sure that the toilet is working properly and there are no leaks.

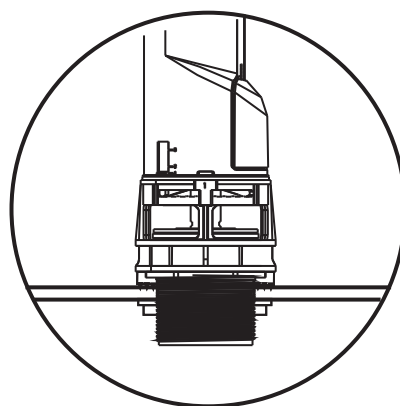
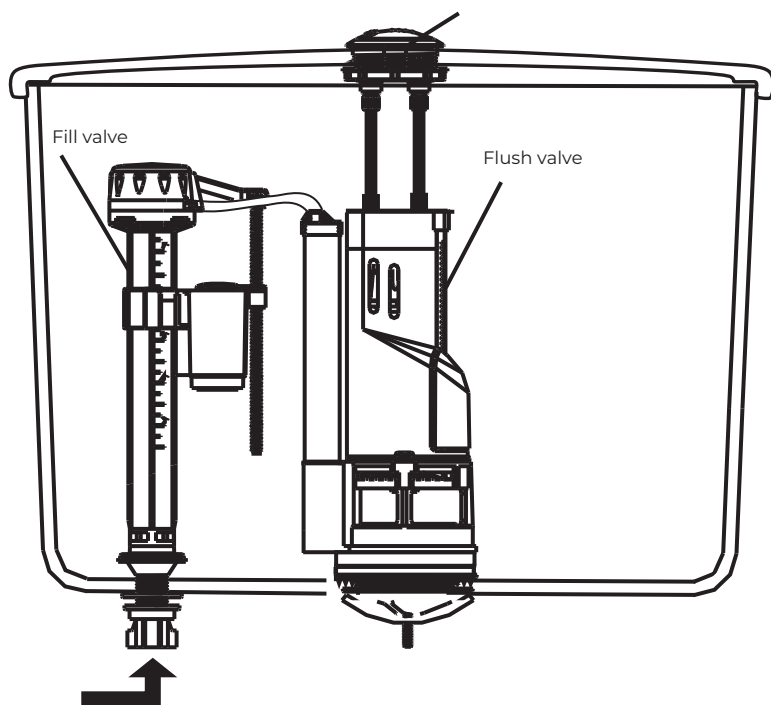

Check before installation

- Check that all product components are complete and undamaged. Any mechanical damage after installation will not be accepted.
- Installation must be carried out on level floors and walls.
- Ceramics and the tank are subject to a manufacturing tolerance of ± 5 mm, which is acceptable.

1. The Installation of fill Valve

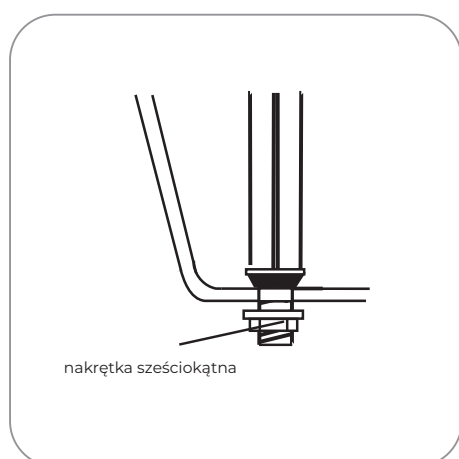

1. Spin the hexagon nut open and put the fill valve into the water-in tank hole, make sure the filter are at the position as shown, screw the hexagon nut tight.

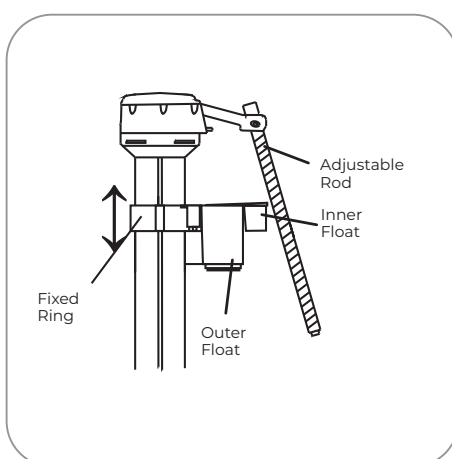

2. Rotate the adjustable rod 90 degree and draw out, move the fixed ring to adjust the float height and water level. Press the inner float, adjustable rod to the lowest position, put the rod back into the inner float, then rotate and fix it.

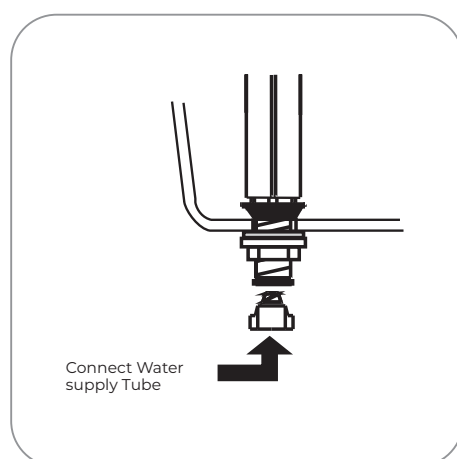

3. Drain out of the water supply tube clean and connect the water supply tube.

2. The Installation of flush valve

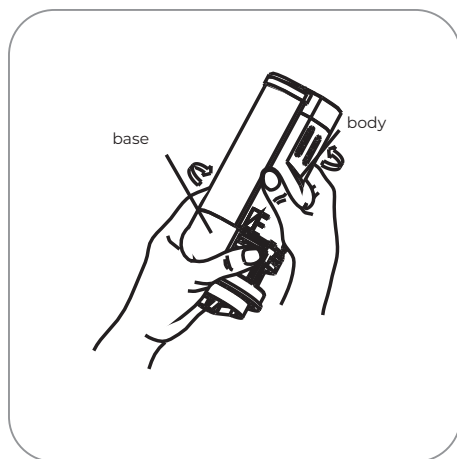

1. Rotate the flush valve body to separate the body from base as shown in the Fig.

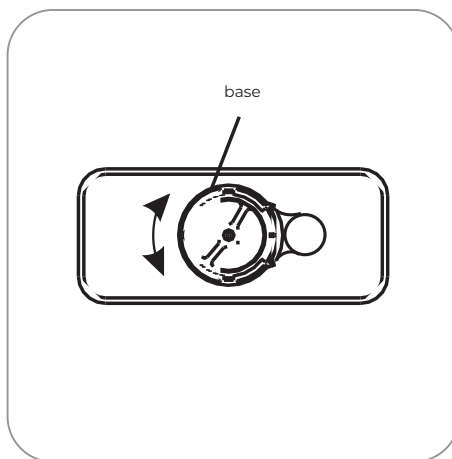

2. Install the flush valve base into the outlet to make the "U" clasp can clip on the tank properly. Rotate the base to choose proper angle and lock the screw.

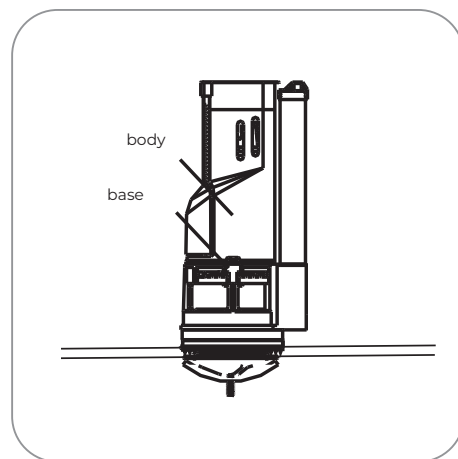

3. Install the flush valve body on the base again, rotate it to a proper position and lock.

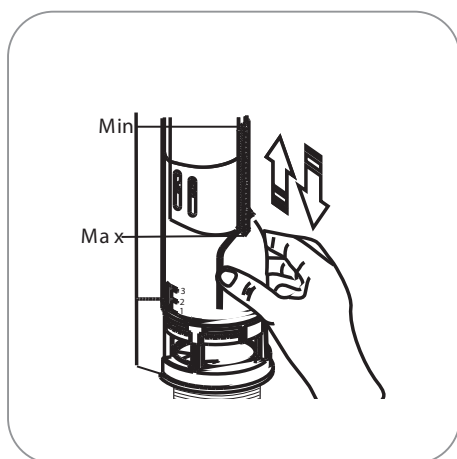

4. When moving the partial flush float from bottom to top, the partial flush volume decreases gradually, The adjustable distance is 60mm(2-1/4").

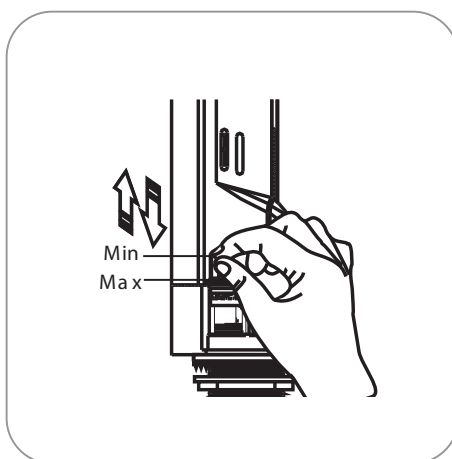

5. When moving the red adjusting piece from bottom to top, the full flush volume decreases gradually, The adjustable distance is 20mm (13-16").

3. The Installation of push button

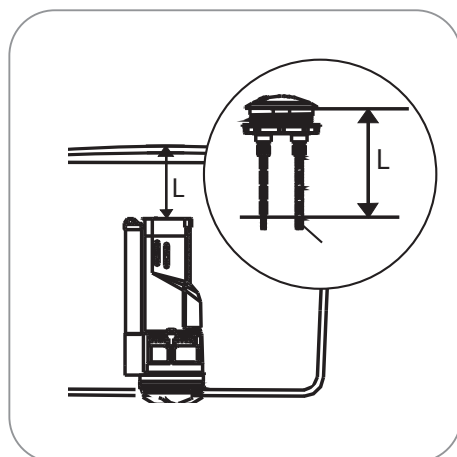

1. "L" must be measured just as showed in figure. To cut off the excess length of the rod.

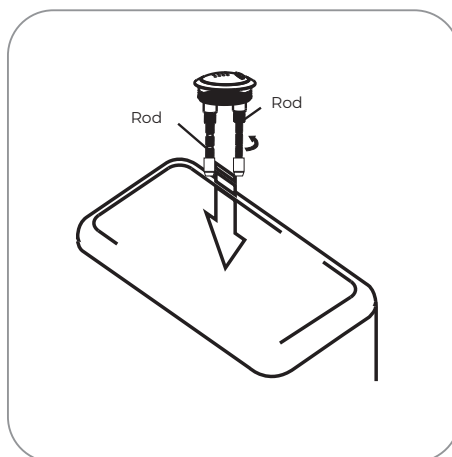

2. Cut the adjustable rod to a proper length, put the push button into the hole.

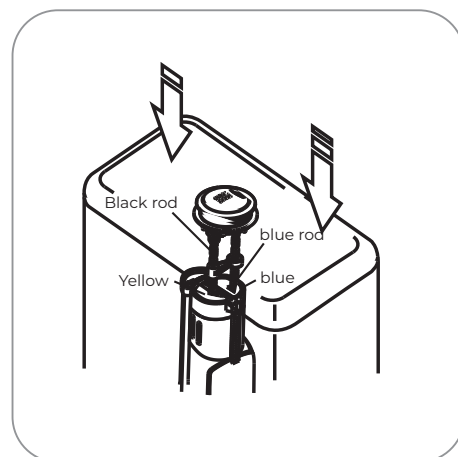

3. Adjust the direction of the push button.

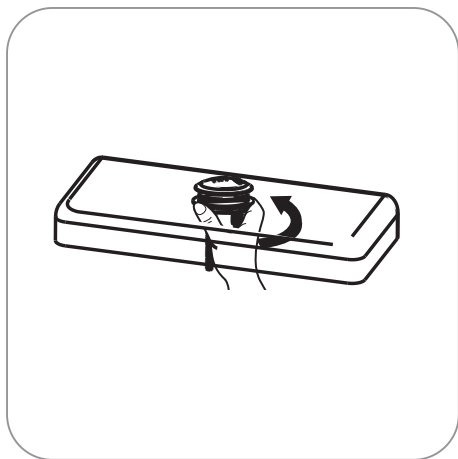

4. Tighten the nut.

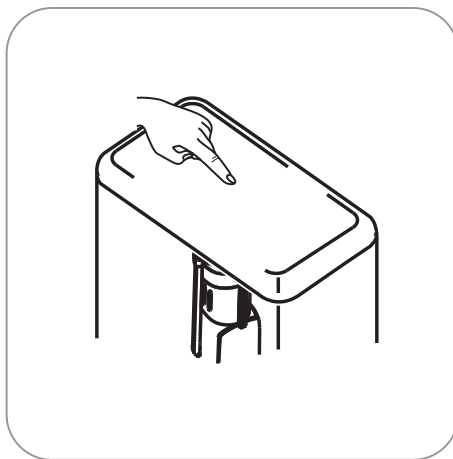

5. Whole flush.

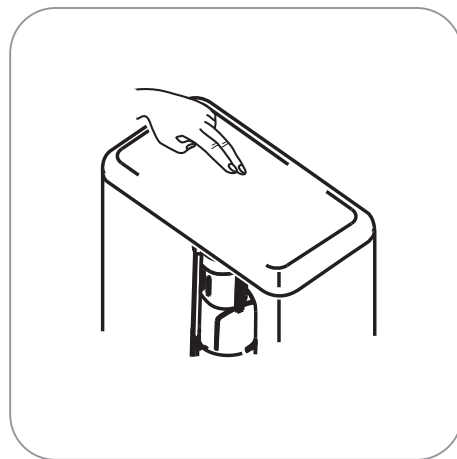

6. Partial flush.

Fault and Resolvent

FAULT	RESOLVENT
No partial flush	Check the fill water level whether is higher than the partial float. If not, adjust the water level higher or adjust the float lower.
No flush or flush less after push down the button.	<ol style="list-style-type: none"> 1. Check the button whether is pushed to the proper position. 2. Check the button rod whether is too short. If yes, adjust the adjustment rod's length.

Note: It is normal that the water flow from the inside of toilet in a moment after flush.

Attention: Please cut down the syphon to suit the overflow level.

WARNING::

Do not use an in-tank type bowl cleaner in your toilet. In-tank cleaners containing chlorine(calcium hypochlorite) can seriously damage fittings in the tank. We shall not be responsible for any tank fitting damage caused by the use of cleaners containing chlorine(calcium hypochlorite). We will not be liable for damages due to improper handling or installation, abuse, or alteration of the product. We disclaims any responsibility for incidental or consequential damages.

Attention: If the product is different from the drawing , Please take the object as right.

Care and maintenance

- Do not use abrasive materials for cleaning, as they may scratch or dull the board and ceramics.
Do not use chemicals that are not approved for use on ceramics and plastics.
- Clean with warm soapy water or vinegar water and wipe with a soft cloth.