

OLTENS

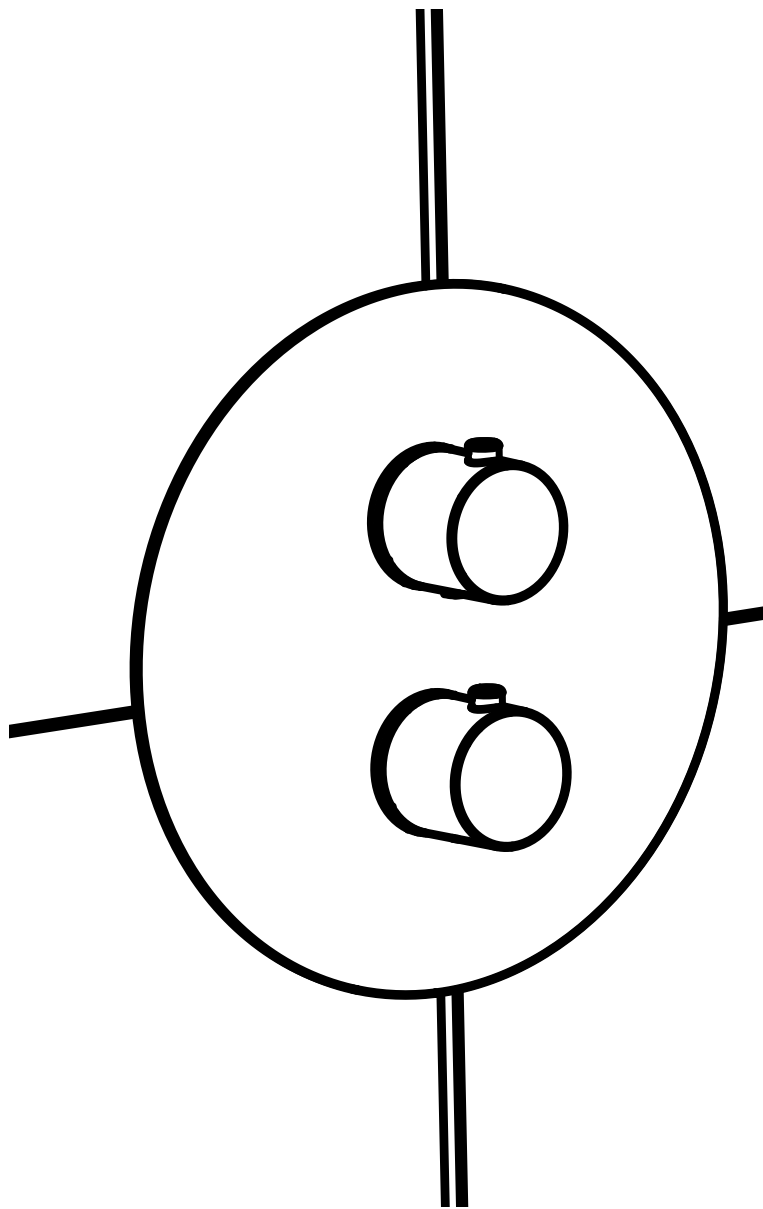

Concealed bath shower mixer tap
– installation instructions

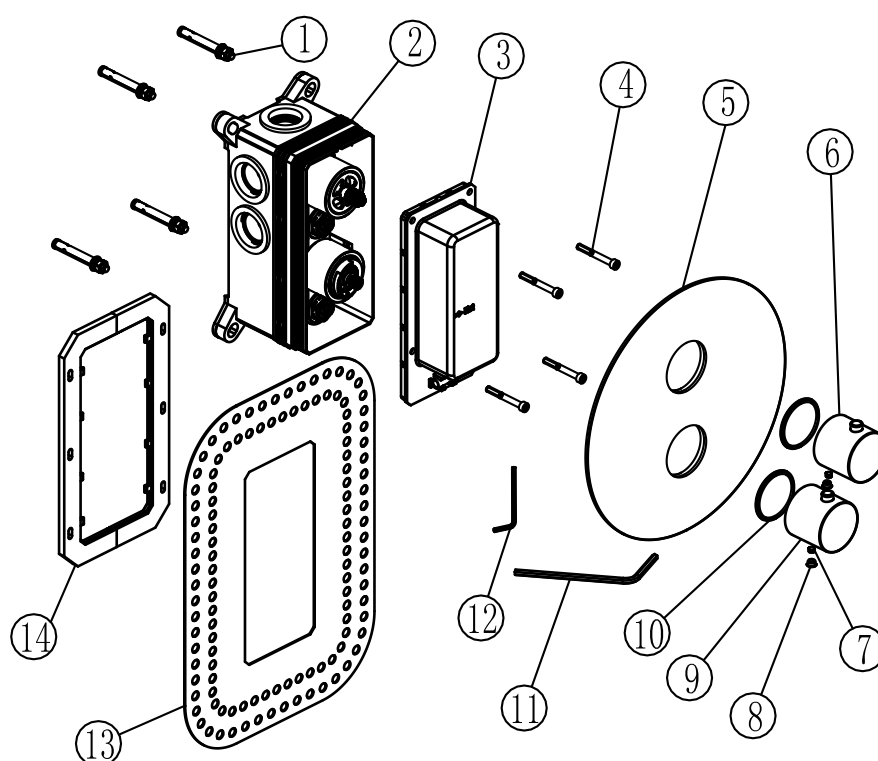

Make sure that all mixer tap components listed in the table are included:

Item No.	Name	Quantity
1.	M6×6 wall plugs	4
2.	Concealed box with valves	1
3.	Box cover	1
4.	M5×40 hex screws	4
5.	Mixer tap cover (rosette)	1
6.	Knob with switch	1
7.	Screws	2
8.	Rubber plug	2
9.	Temperature control knob	1
10.	Plastic ring	2
11.	4 mm Allen key	1
12.	2.5 mm Allen key	1
13.	Rubber sealing plate	1
14.	Plastic frame	2

PREPARATION TO INSTALLATION

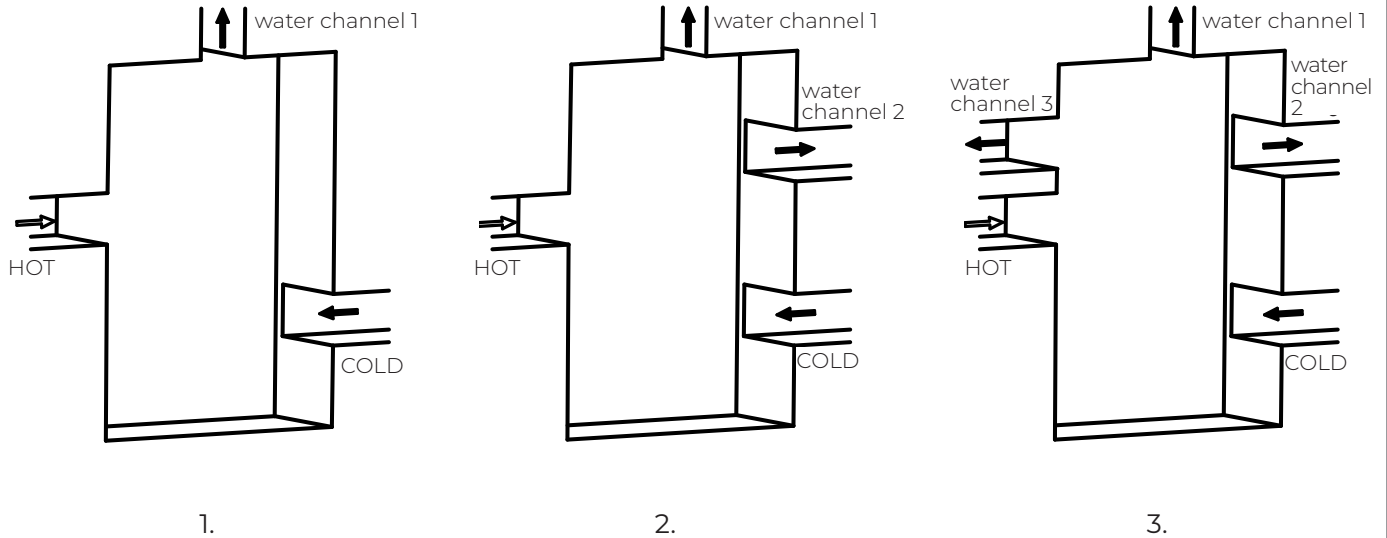

1. Installation drawing for **1-function** shower mixer tap.
2. Installation drawing for **2-function** shower mixer tap.
3. Installation drawing for **3-function** shower mixer tap.

PREPARATION TO BOX INSTALLATION

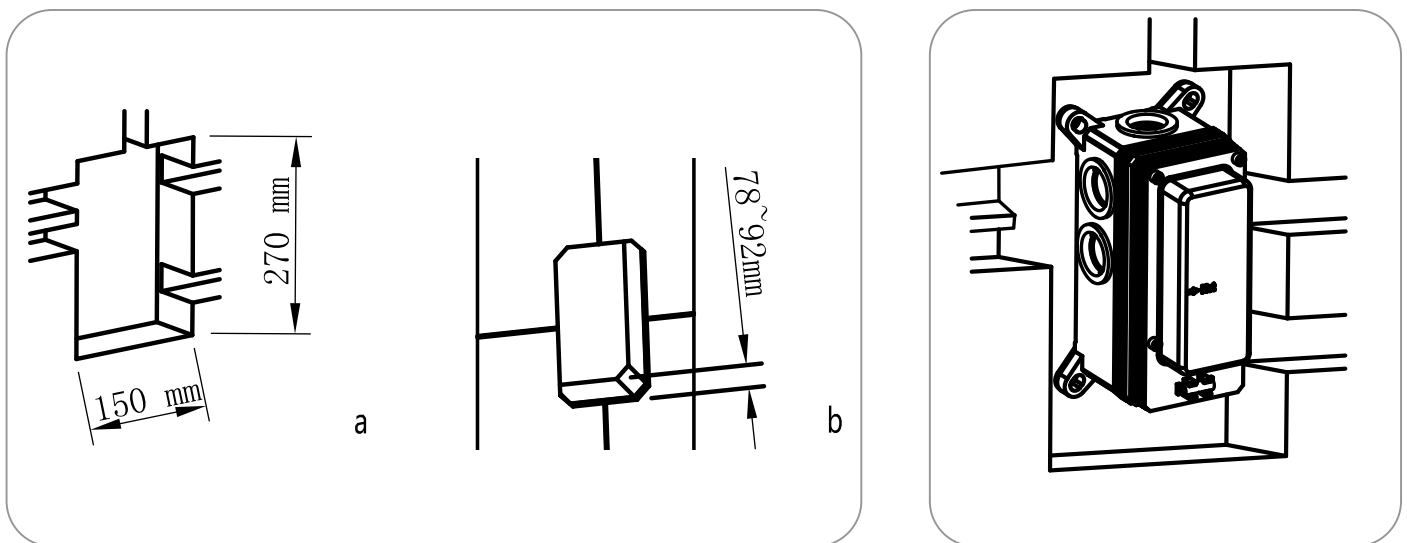
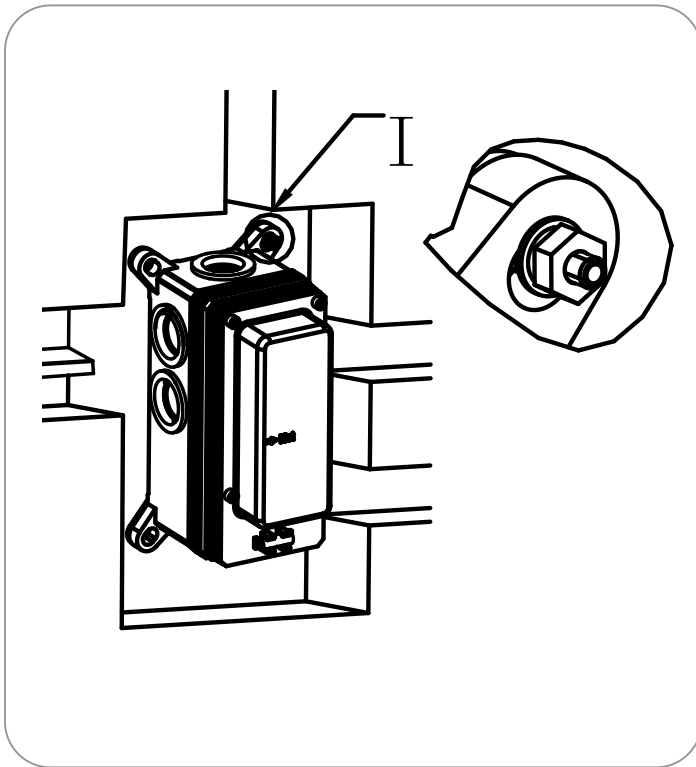

Figure **a** shows the dimensions (length, width) of the wall cavity.

Figure **b** shows the depth of the wall cavity.

Follow the direction shown on the drawing

PREPARATION FOR INSTALLATION IN THE WALL CAVITY



Use 4 pcs of M6×60 wall plugs and a wrench to attach the box to the wall.

Make sure that the box and wall surface are parallel.

Use the spirit level to ensure that the box is installed at the correct level.

If the 1-function

or 2-function tap is used, plug the corresponding outlets with a Teflon sealing tape.

BOX INSTALLATION

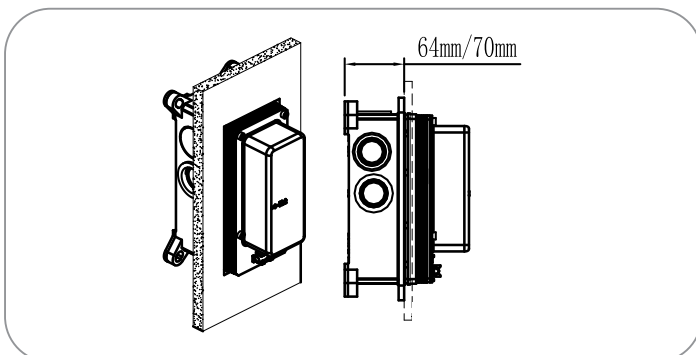
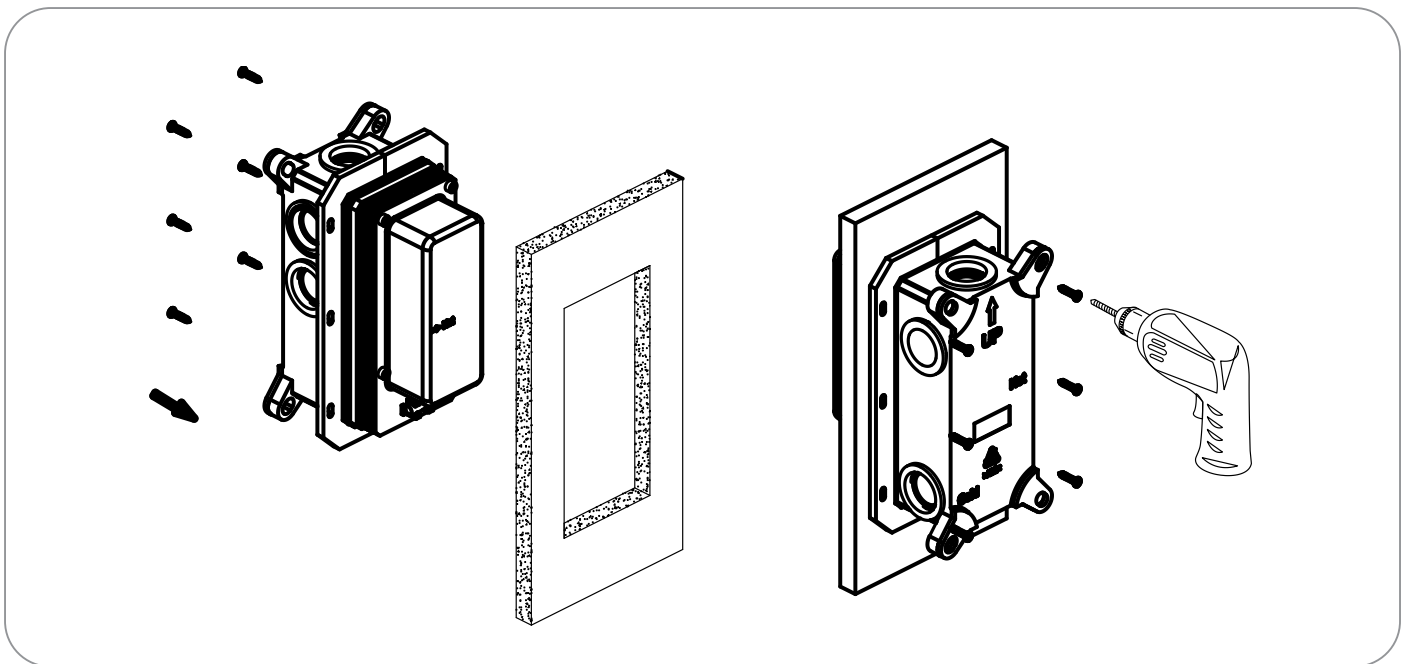

Installation of the main part of the mixer tap

LEAK TEST

Connect the hot and cold water inlets and outlets to the concealed valve.

NOTE!

Before connecting, make sure that the water supply is on and any impurities inside the pipe are completely flushed out.

Close the water supply when the cleaning is finished.

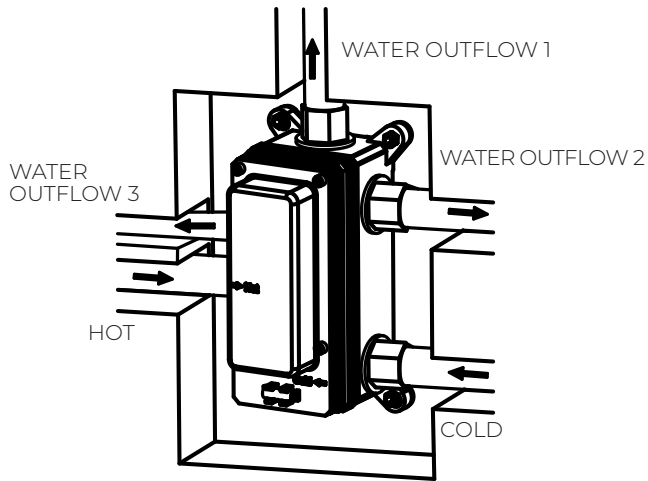

Apply a dynamic water pressure of not less than 0.5 MPa in the water pipe and check the connected parts to ensure that all connected parts are completely tight.

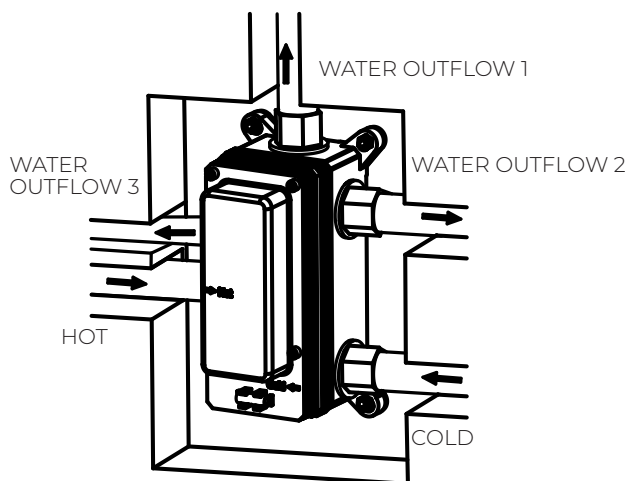

WALL SURFACE SEALING

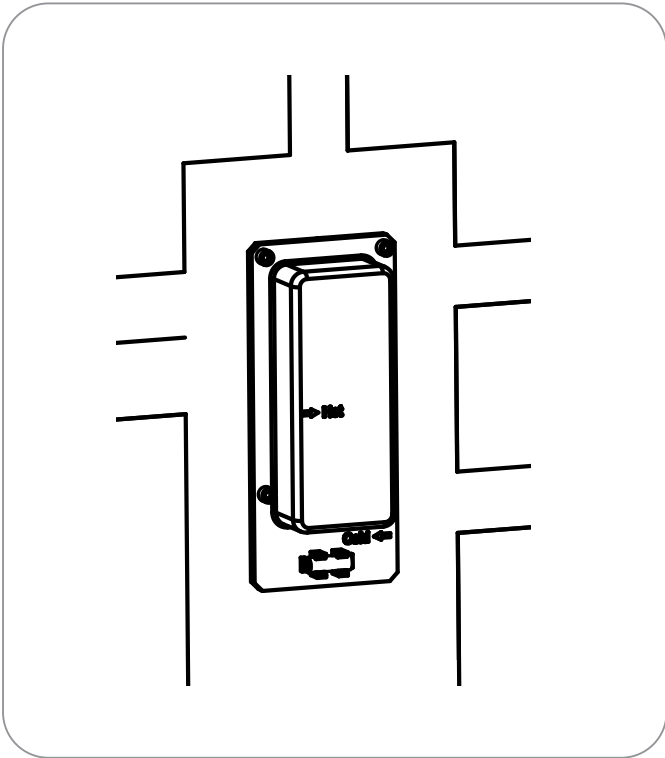

After the leak test to ensure that there are no leaks in all connected parts, use caulking foam to fill all gaps in the wall.

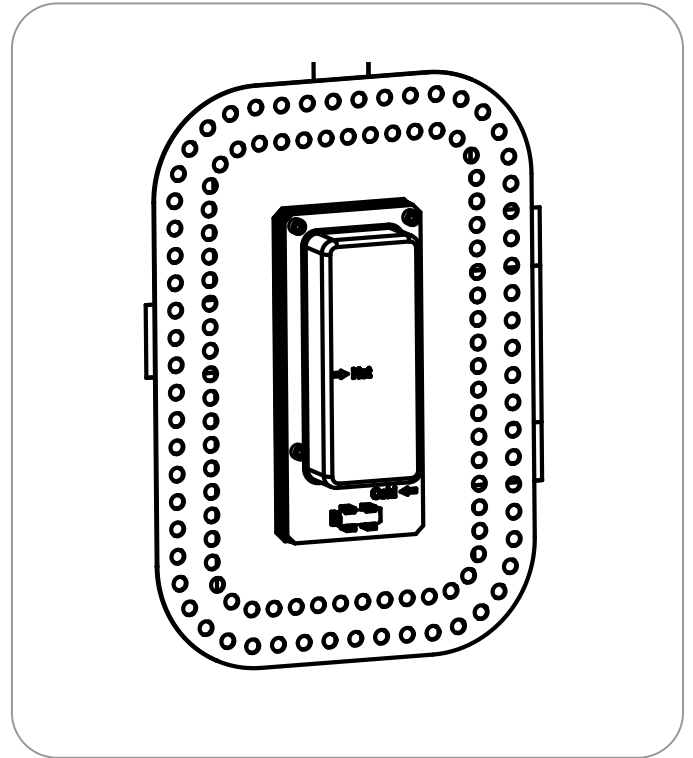

Apply the rubber sealing plate and stick the plate to the wall surface.

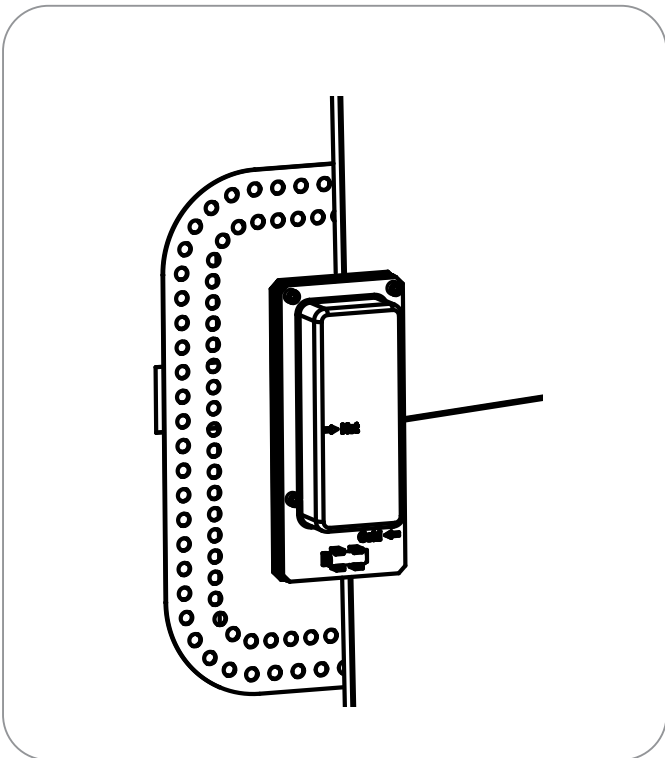

Stick the plate on top of the wall surface; the cut plate should perfectly fit into the installed box.

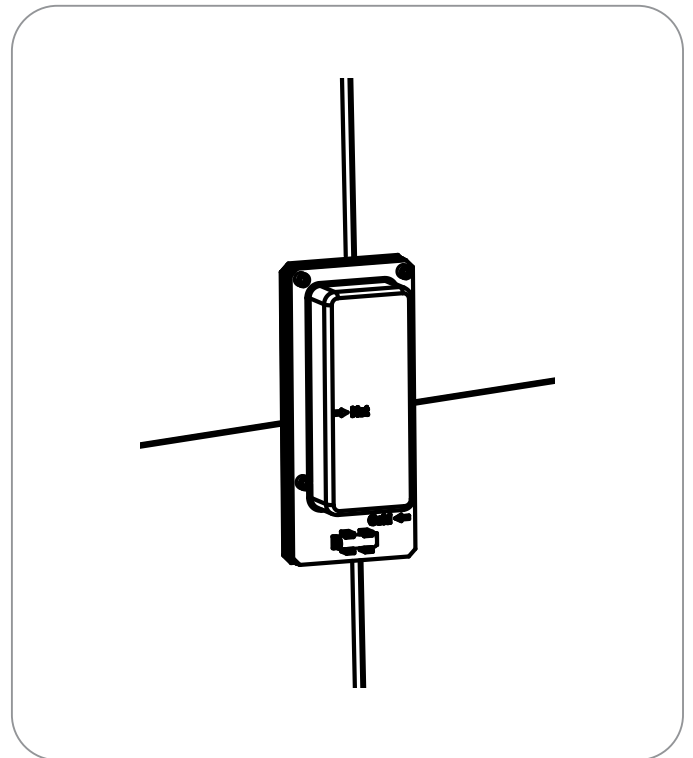

Install the box after laying all the tiles. The next step is to install the mixer tap cover (rosette) and handles.

INSTALLATION OF THE MIXER TAP COVER (ROSETTE) AND HANDLES

1. Use an Allen key to remove the 4 screws; then, remove the top cover of the box with the concealed valves.

2. Use a knife to cut the plastic box to ensure that the plastic box does not protrude beyond the wall surface.

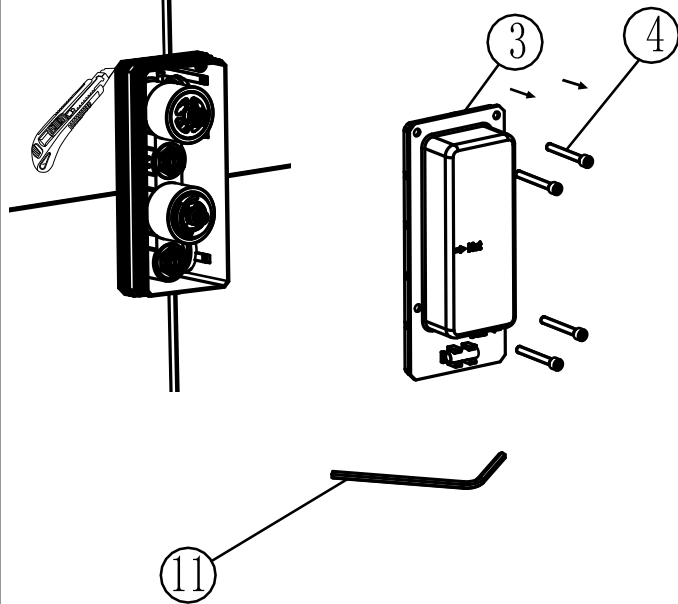

Mount the mixer tap cover (rosette) onto the concealed valves as shown on the drawing.

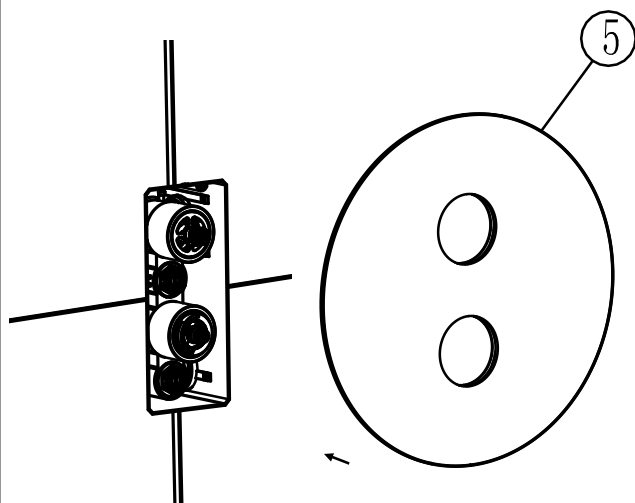

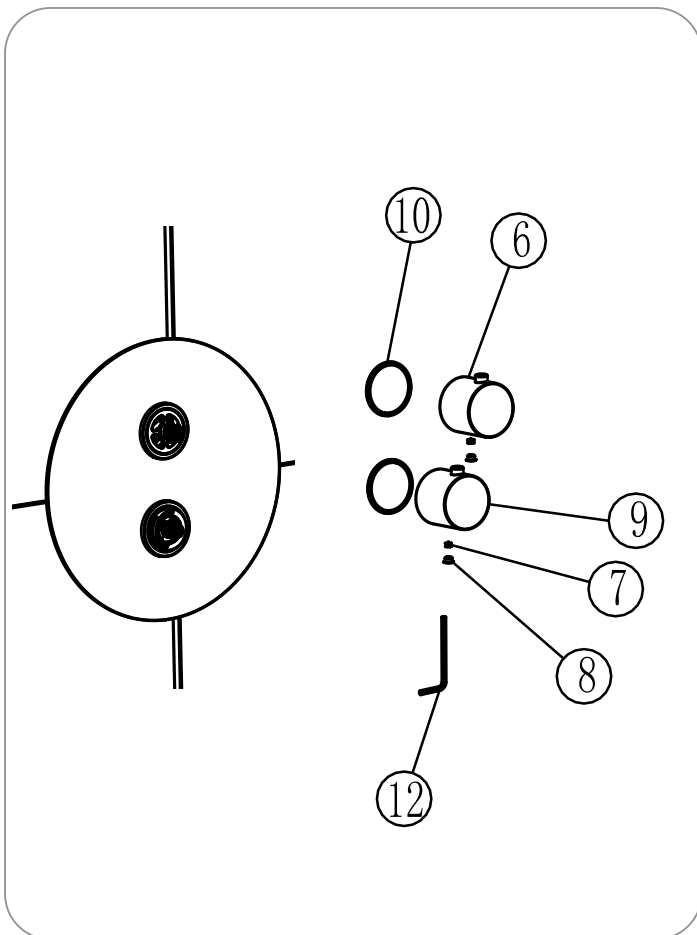

Install the switch handle:

First, make sure that the valve is closed and the button on the switch handle indicates 12 o'clock. Insert part 10 (rings) onto the handle, then use the Allen key to tighten the screw inside the switch knob.

Then, insert the rubber plug into the opening in the switch holder to cover the screw. Install the temperature control handle: First, make sure that when the button on the control handle is pointing upwards to 12 o'clock, the water temperature is $38 \pm 2^\circ\text{C}$. Insert part 10 (rings) onto the handle, then use the Allen key to tighten the screw inside the switch knob.

Then, insert the rubber plug into the opening in the switch holder to cover the screw.

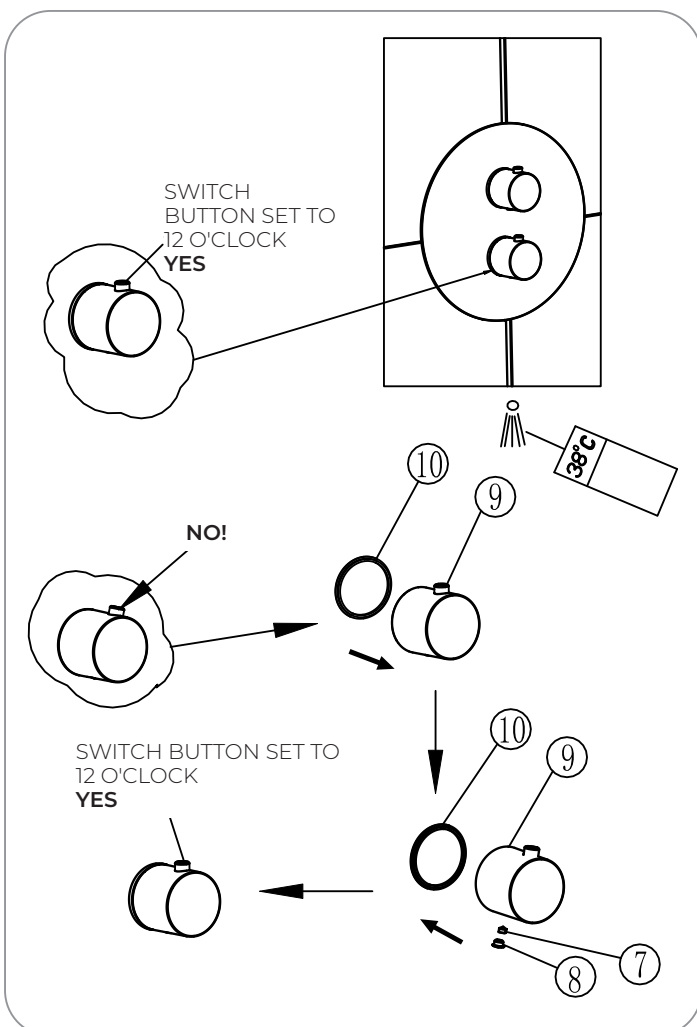

Turn the thermostatic handle.

When water temperature is 38°C (check with a thermometer), but the handle does not indicate 38°C , reinstall the handle (9) and the ring (10) to ensure that the handle indicates 38°C .

Next, install the fastening screw (7) and the plastic cap (8).

INSTALLATION COMPLETE

The bath and shower thermostatic mixer tap is installed.

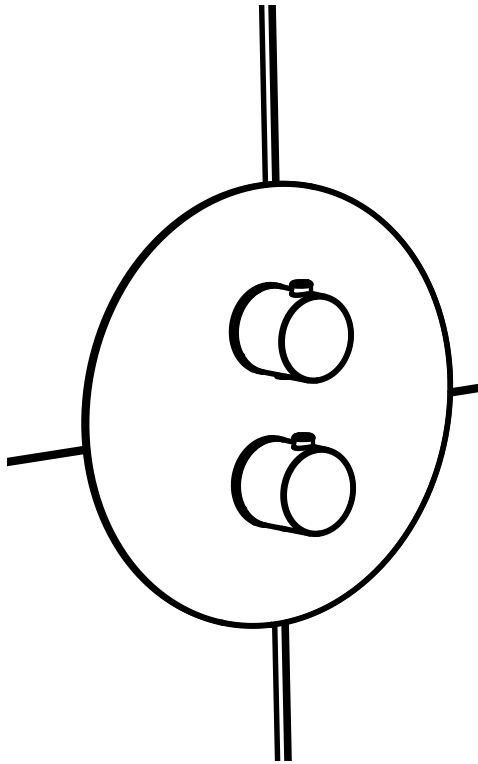

IMPORTANT! *Thermostatic valve head maintenance:* The thermostatic mixer tap must be maintained properly so that there is no scaling and blockage of the head. At least every 3–4 weeks, change the position of the thermostatic valve head knob during water flow from the extreme cold water position to the hot water position and set the water flow to the hand-held shower spray only. To avoid hot water burns, do not stand in the middle and under water flow. Only adults are allowed to perform this step. Repeat it 3–5 times.

Note! The drawings are for illustration and instruction purpose only. The appearance of the mixer tap may be different from that seen in the drawings.

Technical data

Maximum pressure **1 MPa**

Recommended pressure **0.1–0.5 MPa**

Maximum hot water temperature **90°C**

Recommended hot water temperature **65°C**

Make sure that the hot and cold water connections are installed correctly.

Care and maintenance

Flush with clean water and wipe with a dry, soft cloth. For heavier deposits, it is recommended to use special tap cleaning agents, preferably professional Oltens products from the NanoCare and NanoShine series. Never use agents containing alcohol, disinfectants, solvents and strong bases. Never clean the surface of the tap with rough cloths or cleaning agents containing abrasive materials and acids.

